

2006

Hornet

by Keystone



Travel Trailers & Fifth Wheels



Hornet's model 30FKS features a deep double-bowl sink, high-rise faucet and oversize countertop. All cabinetry is securely assembled with screws featuring raised panel upper cabinet doors and solid wood drawer fronts.

Imagine a vacation with less preparation: less packing, less planning and less calling ahead for reservations. Now imagine yourself

in a stylish retreat that includes all the comforts of home. With a wide range of floor plans and features that are seen on more expensive trailers, Hornet gives you a high-end look without the high-end price. Get style. Get value. Get going!



Hornet's 30BHS adds even more versatility with flip-down bunk beds. When flipped up, these remarkably comfortable beds add an additional 180 cubic feet of living space.





Model 30BHS features extra storage areas which are carefully designed to not impede precious floor space.

2006 Hornet Travel Trailers and Fifth Wheels: Standard Features and Options

Interior:

Raised oak cabinet doors (uppers)
 Oak framed cabinet doors (tongue and groove)
 Lumbercore cabinet stiles (screwed together)
 Oak drawer fronts
 AM/FM/CD Stereo with 4 speakers (True Sound DVD: mandatory option)
 Mini blinds
 Decorative light at dinette and pin up light
 Clock
 Swivel Rocker (27RLS, 29RLS, 31FLS, 30FKS, 33FKDS, 33FLDS)
 Second swivel rocker (27RLS & 29RLS)
 Wallpaper border
 Extra large double bowl kitchen sink
 High rise kitchen faucet
 Sink cover
 3 burner range with oven
 Microwave
 6 cubic ft. fridge with temperature control
 Countertop extension (where available)
 Knife rack
 Silverware tray
 Storage door at dinette (1) – booth dinette only
 Bar stools (31FLS & 33FLDS)
 Bedspread with pillows
 Bed lifters
 High density foam mattress
 Foot flush porcelain toilet

Tub surround
 13.5 BTU Roof A/C (models 21RSL, 24RSL, 25FL, optional 19FL)
 13.5 BTU Ducted A/C with "Quick Cool" (models 27' and larger)
 6 Gallon gas/electric water heater w/ DSI
 TV antenna & cable hookup

Exterior:

.024 gauge mesa metal exterior
 Tinted safety glass
 Diamond plate front rock guard
 Stabilizer jacks (optional 19FL)
 Dual 30-lb. LP bottles with cover and auto change
 Ultra lube axles
 Awning (optional 19FL)
 Hitch light
 Enclosed and heated fresh water tank
 EZ glider entry step
 White radius clamping windows
 Rubber roof
 Drip rails and downspouts
 Pass-thru storage (most models)
 Electric slide mechanism(s) (single slide models and 27FLDS / 28BHDS)
 Hydraulic slide mechanisms (33FLDS, 33FKDS, 32BHDS)

Optional Equipment:

15,000 BTU A/C with "Quick Cool" in place of 13.5 BTU A/C (models 27'

and above)
 True Sound Entertainment System with DVD (Mandatory option - all models)
 Patio door with vertical blind (30FKS, 31FLS, 33FLDS, 33FKDS, 36BHS)
 Quad bunk, front bedroom (36BHS only)
 Residential refrigerator (36BHS only)
 8 cu ft. fridge (33FLDS, 33FKDS, 36BHS only)
 Free standing table and chairs (N/A 21RSL, 24RSL, 27B, 29FBS)
 Hide-A-Bed sofa (N/A 21RSL, 24RSL, 27B, 29FBS)
 Garden shower (27FLDS, 29RLS, 30FKS, 31FLS, 32BHDS, 33FKDS, 33FLDS)
 Spare tire carrier and cover
 Exterior shower
 Rear ladder (N/A 21RSL, 24RSL, 28BHDS)
 Camping Plus Package includes 13.5 BTU Roof A/C, Awning, Stabilizer Jacks (19FL only)
 Carbon monoxide detector (Mandatory)
 RVIA
 CSA

Hornet

by Keystone

19FL

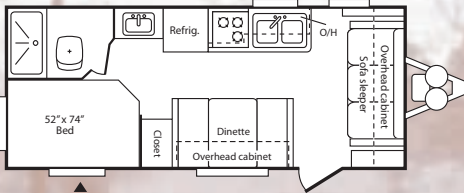

27FLDS

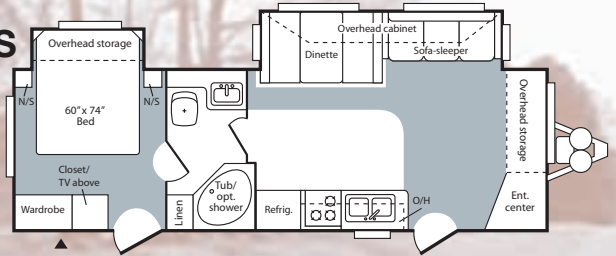

21RSL

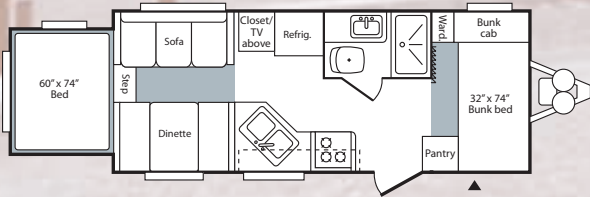

27RLS



24RSL

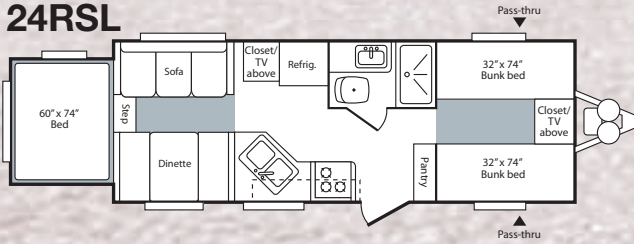

28BHDS

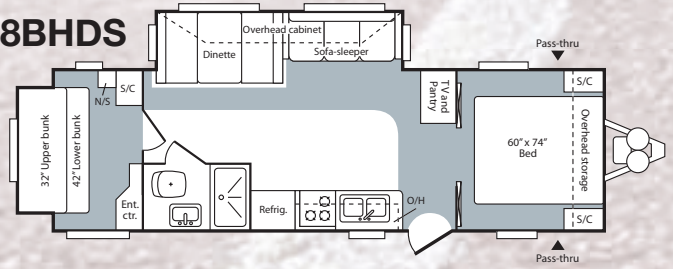

25FL

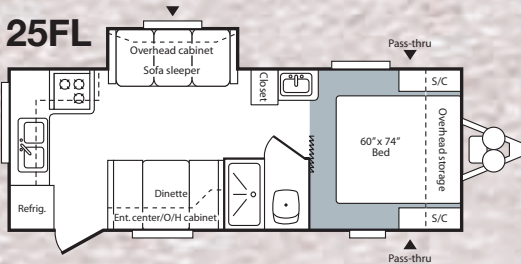

29FBS

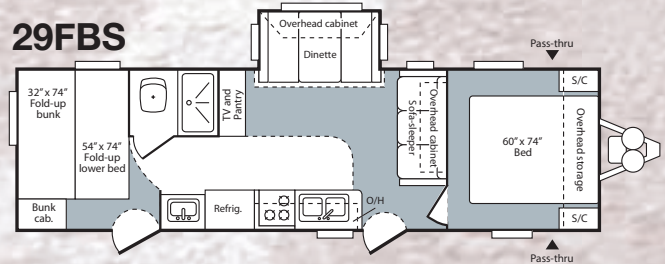

27B

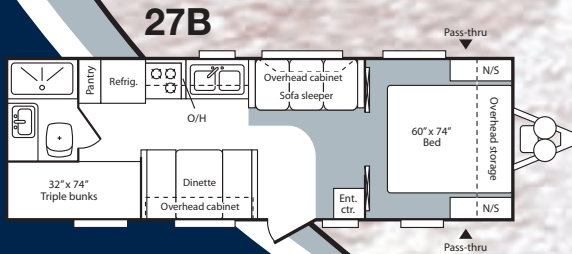

29RLS

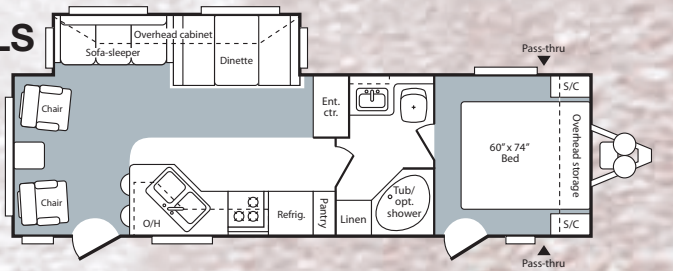

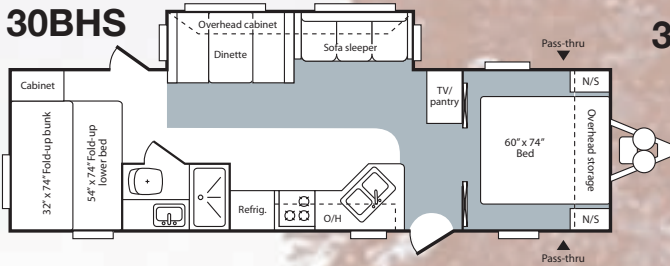
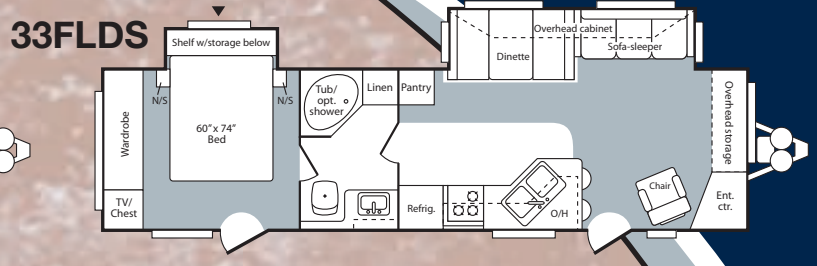
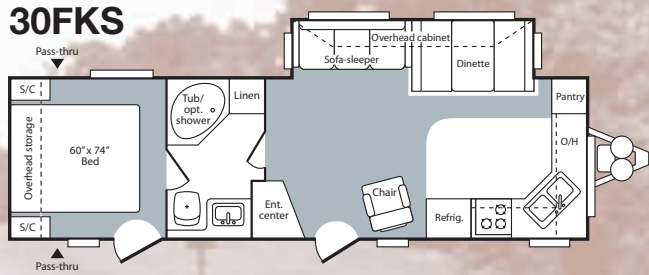
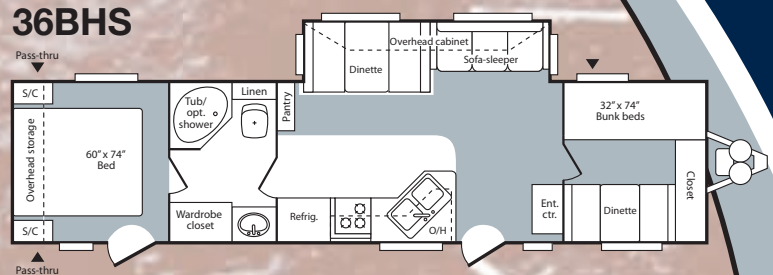
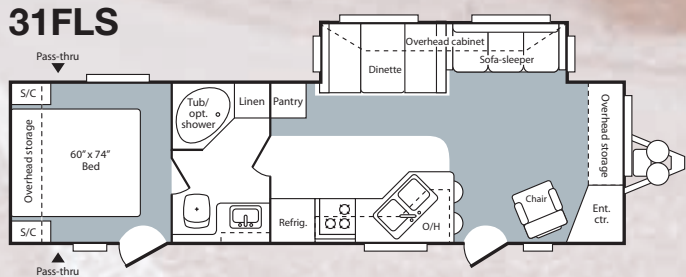
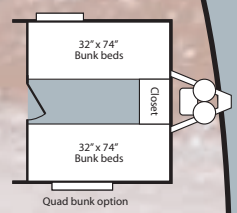
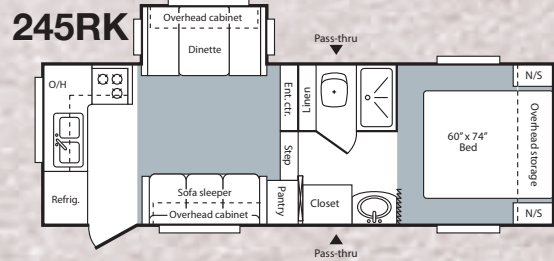
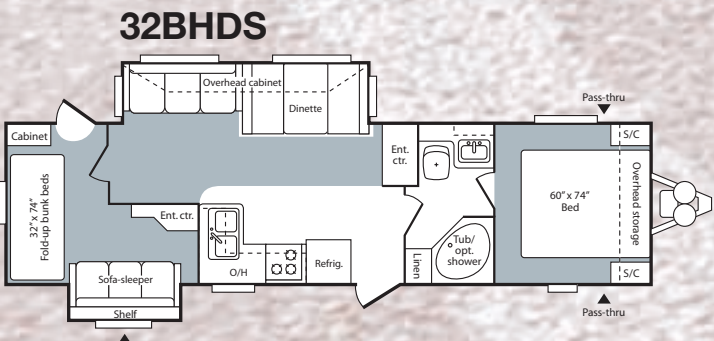
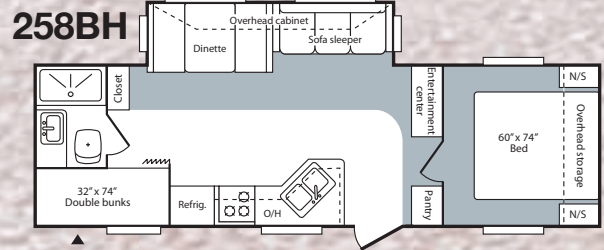
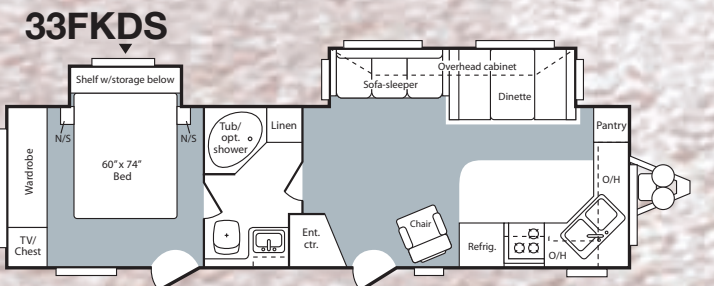
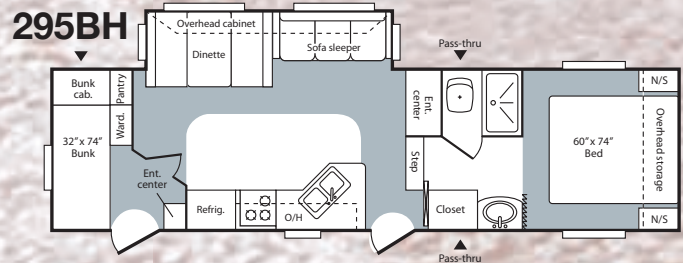
30BHS**33FLDS****30FKS****36BHS****31FLS****36BHS****KEY: ▲ Outside Storage****Fifth Wheels****245RK****32BHDS****258BH****33FKDS****295BH**



All Hornet Retreat models feature a full-wall wardrobe in the bedroom (above) as well as a bed slide to give you the spacious feel of home. The large bathroom offers additional closet space as well as a large garden tub (shown) or optional shower.

Hornet

by Keystone

Retreat

You look forward to the many conveniences and comforts an RV provides; it's the ultimate freedom vehicle! So whether you choose to travel on the weekend or park at a permanent campsite, the Retreat's residential features and special towable design allow for maximum flexibility.

38BHDS

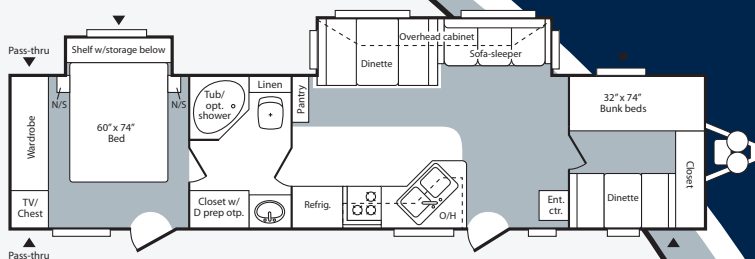

38DQDS

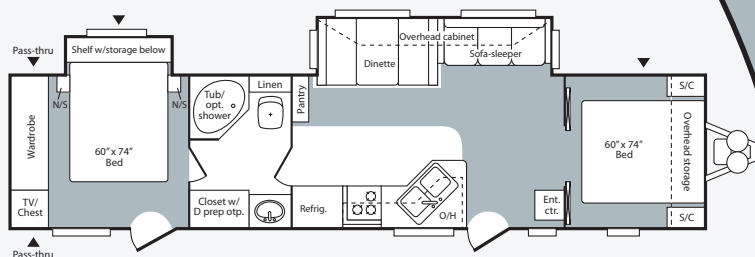

38FLDS

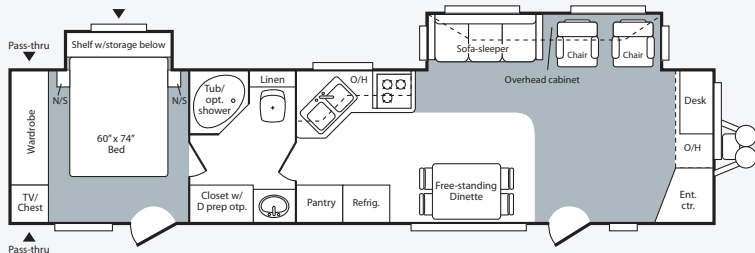

2006 Hornet Retreat: Standard Features and Options

Interior:

- Raised oak cabinet doors (uppers)
- Oak framed cabinet doors (tongue and groove)
- Lumbercore cabinet stiles (screwed together)
- Oak drawer fronts
- AM/FM/CD Stereo with 4 speakers (True Sound DVD: mandatory option)
- Mini blinds
- Decorative light at dinette and pin up light
- Clock
- 2 Swivel rockers (38FLDS only)
- Wallpaper border
- Extra large double bowl kitchen sink
- High rise kitchen faucet
- Water purifier
- Sink cover
- 3 burner range with oven
- Microwave
- 8 cubic ft. fridge with temperature control
- Countertop extension
- Knife rack
- Silverware tray
- Foot flush porcelain toilet

- Storage door at dinette (1) – booth dinette only
- Bedsprad with pillows
- Bed lifters
- High density foam mattress
- Tub surround
- 15.0 BTU Ducted A/C with "Quick Cool"
- 6 Gallon gas/electric water heater with DSI
- TV antenna & cable hookup
- Exterior Shower

Exterior:

- .024 gauge mesa metal exterior
- Tinted safety glass
- Diamond plate front rock guard
- Dual 30-lb. LP bottles with cover and auto change
- Ultra lube axles
- Awning
- Hitch light
- Enclosed and heated fresh water tank
- Large folding entry assist handle
- EZ glider entry step
- White radius clamping windows
- Rubber roof

- Drip rails and downspouts
- Pass-thru storage (most models)
- Hydraulic slide mechanisms

Optional Equipment:

- Prep for second A/C (requires 50 AMP service)
- 50 AMP service
- Washer/Dryer prep with 50 AMP Service
- 10 gallon gas/electric water heater with DSI
- True Sound Entertainment System with DVD (Mandatory option - all models)
- Residential Refrigerator
- Patio door with vertical blind
- Free standing table and chairs (standard in 38FLDS)
- Hide-A-Bed sofa
- Quad bunk (in front of 38BHDS only)
- Garden shower
- Spare tire carrier and cover
- Stabilizer jacks
- Rear ladder
- Carbon monoxide detector (Mandatory)
- CSA

It's all in the details!

1. Full size cabinets in the slide room add to the already abundant interior storage.
2. Ultra-lube axles eliminate the need to re-pack your bearings.
3. Stabilizer jacks standard on all models (excluding Hornet Retreat).
4. Look for the [▲] on Hornet floor plans for the location of exterior access (pass-thru on most models) storage space.
5. Large windows help to enhance your views. Tinted safety glass is standard on all models.
6. The oversized residential kitchen sink is large enough for pots and pans.
7. 30# LP bottles with cover and hitch light. The diamond plate front rock guard helps to protect from road debris.
8. Extra storage space under your sofa is an added convenience (not available with hide-a-bed option).



	Hornet Travel Trailers											
	19FL	21RSL	24RSL	25FL	27B	27RLS	27FLDS	28BHDS	29FBS	29RLS	30FKS	30BHS
GVWR	6525	6605	7605	6585	7650	10,000	10,000	10,000	10,000	10,000	10,000	10,000
Gross Dry Weight	3950	5020	5460	4795	4780	6375	6765	6475	6340	6935	6840	6670
Carrying Capacity	2575	1585	2145	1790	2870	3625	3235	3525	3660	3065	3160	3330
Hitch (as weighted)	525	605	605	585	650	840	965	830	920	780	900	675
Ext. Length	22' 10"	23' 10"	26' 2"	25' 7"	28' 5"	29' 0"	29' 10"	30' 10"	32' 3"	31' 10"	32' 2"	33' 0"
Ext. Height (A/C top)	10' 0"	10' 0"	10' 1"	10' 0"	10' 1"	10' 9"	10' 9"	10' 1"	10' 9"	10' 9"	10' 9"	10' 9"
Fresh Water (Gal.)	45	45	45	45	45	45	45	45	45	45	45	45
Waste Water (Gal.)	38	38	38	32	32	38	38	38	38	38	38	38
Grey Water (Gal.)	38	38	38	70	38	38	38	38	38	38	76	38
Tire Size	205/75D14C	205/75D14C	205/75D14C	205/75D14C	205/75D14C	225/75D15D	225/75D15D	225/75D15D	225/75D15D	225/75D15D	225/75D15D	225/75D15D
Awning Length	16'	16'	16'	16'	16'	21'	16'	18'	18'	18'	18'	18'

	Hornet Travel Trailers						Fifth Wheels			Hornet Retreat		
	31BHS	31FLS	32BHDS	33FKDS	33FLDS	36BHS	245RK	258BH	295BH	38BHDS	38DQDS	38FLDS
GVWR	10,000	10,000	11,060	11,220	11,225	10,000	10,000	TBD	11,500	11,390	11,365	11,245
Gross Dry Weight	7105	6985	7870	7690	7895	7790	6510	TBD	7700	8575	8390	8670
Carrying Capacity	2895	3105	3190	3530	3330	2210	3490	TBD	3800	2815	2975	2575
Hitch (as weighted)	770	1035	900	1060	1065	1195	1205	TBD	1540	1230	1205	1085
Ext. Length	33' 9"	33' 6"	35' 6"	34' 2"	35' 6"	38' 2"	25' 11"	28' 2"	31' 8"	39' 10"	39' 10"	39' 10"
Ext. Height (A/C top)	10' 10"	10' 10"	10' 10"	10' 10"	10' 10"	10' 10"	11' 8"	11' 8"	11' 8"	10' 10"	10' 10"	10' 10"
Fresh Water (Gal.)	45	45	45	45	45	45	45	45	45	45	45	45
Waste Water (Gal.)	38	38	38	38	38	38	38	38	38	38	38	38
Grey Water (Gal.)	38	38	76	76	38	38	70	38	76	38	38	38
Tire Size	225/75D15D	225/75D15D	225/75D15D	225/75D15D	225/75D15D	225/75D15D	225/75D15D	225/75D15D	225/75D15D	225/75D15D	225/75D15D	225/75D15D
Awning Length	18'	18'	16'	21'	21'	21'	16'	TBD	21'	21'	21'	21'

Product information and photography are as accurate as possible at the time of publication. Colors and finishes are photographic representations and may appear differently when viewing actual materials. Features shown are not available on all models. Some features shown are options. Features, prices and specifications are subject to change without notice. 11/05

Your Hornet Dealer:



Keystone RV Company



Keystone RV Company • 2642 Hackberry Dr., Goshen, IN 46526
574-535-2100 • www.keystone-hornet.com